

BENCH MARK

W. Bolt of Fire Hydrant, 24" S. of N.W. corner of site,
E. side of Jasonway Avenue.
Elev. 787.53
(U.S.G.S. Datum)

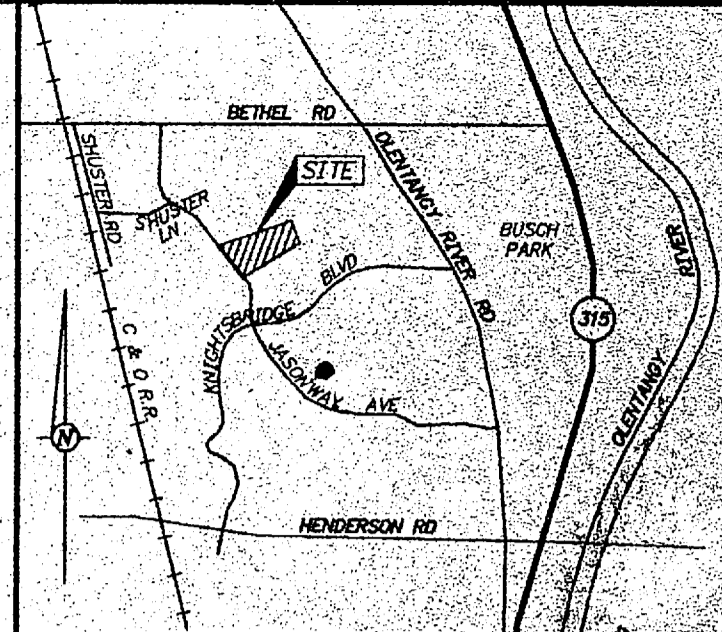
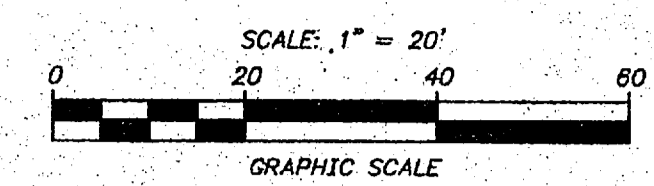

Spirit Holding Company, Inc.
Original 5.001 Ac.
O.R. 13752, Pg. A 01
O.R. 13752, Pg. B 07

Olentangy Park
5.811 Ac.
O.R. 4784, Pg. A 03

Morgan Lumber Sales Company
0.930 Ac.
O.R. 7081, Pg. D 20

$R=576.90'$
 $\Delta=11^\circ 02' 02''$
 $Ch=110.93'$
 $N 29^\circ 58' 57'' W$

<p>1 CURVE DATA $\Delta = 90^\circ 00' 00''$ $R = 31.50'$ $L = 49.48'$ $Ch = 44.55'$ $T = 31.50'$</p>	<p>2 RETURN DATA F/C $\Delta = 84^\circ 18' 09''$ $R = 25.00'$ $L = 36.78'$ $Ch = 33.53'$ $T = 22.63'$</p>	<p>3 RETURN DATA F/C $\Delta = 90^\circ 00' 00''$ $R = 5.00'$ $L = 7.85'$ $Ch = 7.07'$ $T = 5.00'$</p>	<p>4 RETURN DATA F/C $\Delta = 90^\circ 00' 00''$ $R = 4.00'$ $L = 6.28'$ $Ch = 5.66'$ $T = 4.00'$</p>	<p>5 RETURN DATA F/C $\Delta = 90^\circ 00' 00''$ $R = 10.00'$ $L = 15.71'$ $Ch = 14.14'$ $T = 10.00'$</p>	<p>6 RETURN DATA F/C $\Delta = 90^\circ 00' 00''$ $R = 2.00'$ $L = 3.14'$ $Ch = 2.83'$ $T = 2.00'$</p>	<p>7 RETURN DATA F/C $\Delta = 90^\circ 00' 00''$ $R = 2.00'$ $L = 3.14'$ $Ch = 2.83'$ $T = 2.00'$</p>	<p>8 RETURN DATA F/C $\Delta = 74^\circ 38' 19''$ $R = 10.00'$ $L = 13.02'$ $Ch = 12.12'$ $T = 7.62'$</p>	<p>9 RETURN DATA F/C $\Delta = 164^\circ 36' 19''$ $R = 25.00'$ $L = 50.26'$ $Ch = 42.22'$ $T = 39.39'$</p>	<p>10 RETURN DATA F/C $\Delta = 105^\circ 23' 41''$ $R = 3.00'$ $L = 5.52'$ $Ch = 4.77'$ $T = 3.94'$</p>	<p>11 RETURN DATA F/C $\Delta = 164^\circ 36' 19''$ $R = 25.00'$ $L = 50.26'$ $Ch = 42.22'$ $T = 39.39'$</p>	<p>12 RETURN DATA F/C $\Delta = 115^\circ 11' 39''$ $R = 25.00'$ $L = 50.26'$ $Ch = 42.22'$ $T = 39.39'$</p>	<p>13 RETURN DATA F/C $\Delta = 105^\circ 23' 41''$ $R = 5.00'$ $L = 9.20'$ $Ch = 7.95'$ $T = 7.47'$</p>	<p>14 RETURN DATA F/C $\Delta = 180^\circ 00' 00''$ $R = 0.92'$ $L = 2.88'$ $Ch = 1.83'$ $T = 14.14'$</p>	<p>15 RETURN DATA F/C $\Delta = 70^\circ 31' 44''$ $R = 20.00'$ $L = 24.62'$ $Ch = 23.09'$ $T = 14.14'$</p>	<p>16 RETURN DATA F/C $\Delta = 109^\circ 28' 16''$ $R = 3.00'$ $L = 5.73'$ $Ch = 4.90'$ $T = 4.24'$</p>	<p>17 RETURN DATA F/C $\Delta = 123^\circ 38' 02''$ $R = 4.00'$ $L = 8.63'$ $Ch = 7.05'$ $T = 7.47'$</p>	<p>18 RETURN DATA F/C $\Delta = 54^\circ 06' 05''$ $R = 10.00'$ $L = 14.44'$ $Ch = 12.07'$ $T = 5.11'$</p>	<p>19 RETURN DATA F/C $\Delta = 135^\circ 00' 00''$ $R = 5.00'$ $L = 11.78'$ $Ch = 9.24'$ $T = 12.07'$</p>	<p>20 RETURN DATA F/C $\Delta = 45^\circ 00' 00''$ $R = 5.00'$ $L = 3.93'$ $Ch = 3.83'$ $T = 2.07'$</p>
--	---	---	---	---	---	---	--	--	---	---	---	---	--	--	---	---	---	---	--

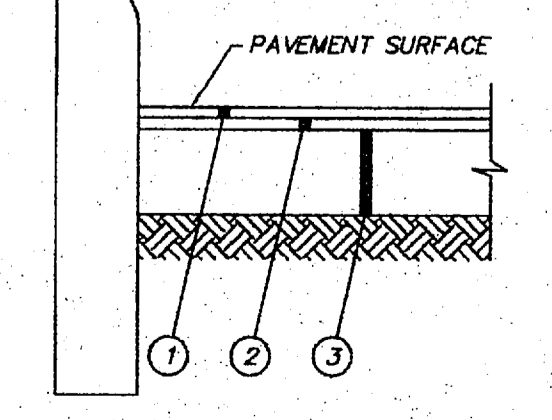

STANDARD PAVEMENT SECTION
NO SCALE

- 1 1-1/2" HOT MIXED, HOT LAID ASPHALT CONCRETE (85-100), ITEM 404
- 2 1-1/2" HOT MIXED, HOT LAID ASPHALT CONCRETE (85-100), ITEM 402
- 3 6" AGGREGATE BASE, ITEM 304
- 4 STRAIGHT 18" CONCRETE CURB PER CITY OF COLUMBUS STD. DWG. 2000 DR. A
- 5 HEAVY DUTY PAVEMENT SHALL BE MODIFIED AS FOLLOWS:
- 6 8" AGGREGATE BASE, ITEM 304

- 7 - Handicap Space
- 8 - Proposed paint striping (no parking zone)
- NOTE: All dimensions are to the face of curb unless otherwise noted.
- 9 - Indicates Areas for Heavy Duty Pavement.

PRELIMINARY

SUBJECT TO REVISION AND NOT TO BE USED FOR CONSTRUCTION

C.F. BIRD & R.J. BULL, INC.
ENGINEERS / SURVEYORS
2875 W. DUBLIN - GRANVILLE RD.
COLUMBUS, OHIO

STAKING PLAN FOR JASONWAY MEDICAL CENTER