

This drawing and the material appearing herein, constitute original and unpublished work of Feinknopf Macioce Schapp Architects, Inc. and may not be used on any project for any purpose, nor may the same be copied (except by the governmental agencies required by law), or disclosed without the written consent of the architect.

© COPYRIGHT FEINKNOPF MACIOCE SCHAPPA, ARCHITECTS, INC. 1996

PROJECT #	95062-01	PROJECT MANAGER	DLAB
DATE	7-1-1996	DRAWN BY	AMP
SCALE	AS NOTED (48)	REVIEWED BY	DFG

NOTES

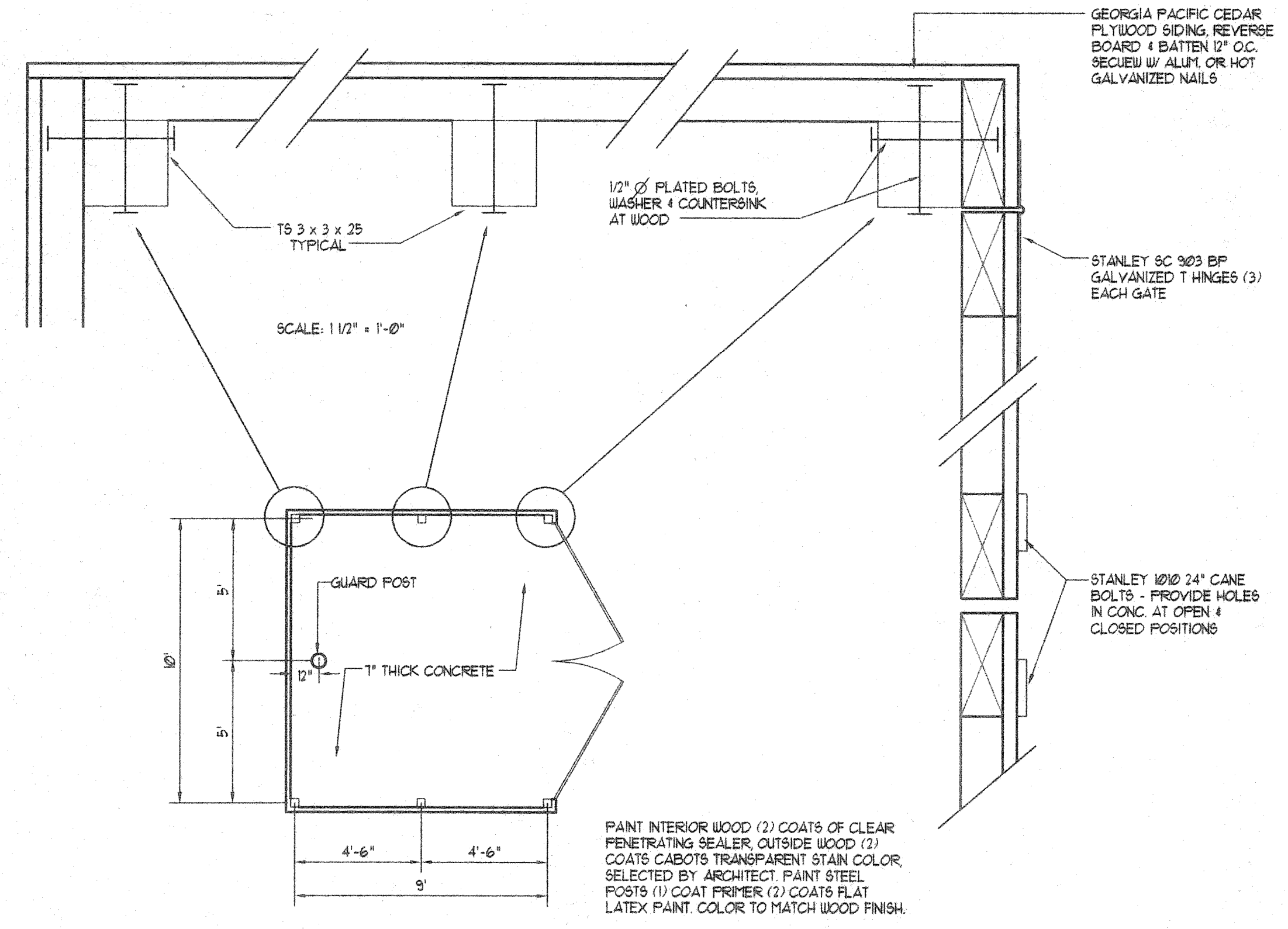

1 TRASH ENCLOSURE DETAILS
SP-1 1/4" = 1'-0"

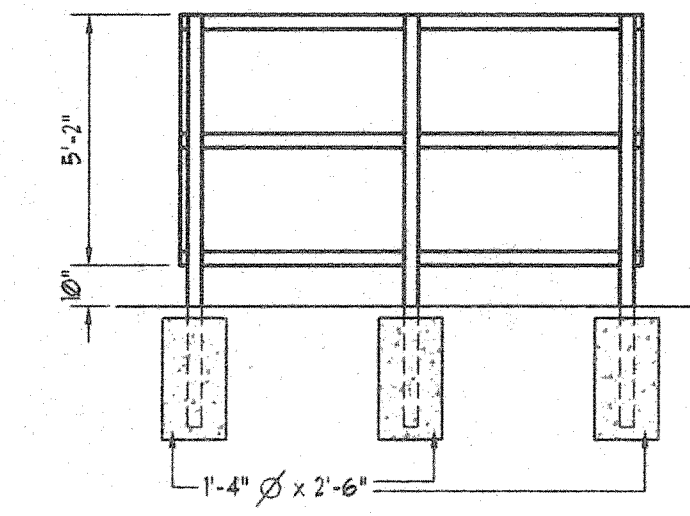

2 ELEVATION
SP-1 1/4" = 1'-0"

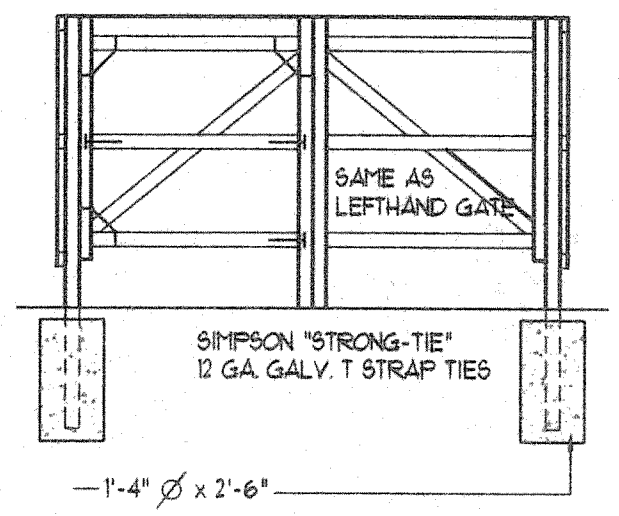

3 ELEVATION
SP-1 1/4" = 1'-0"

NO. PERSON DESCRIPTION DATE

**FEINKNOPF
MACIOCE
SCHAPPA
Architects, Inc.**

274 Marconi Boulevard, Columbus, Ohio 43215
tele (614) 221-3192 fax (614) 221-560

JASONWAY MEDICAL
OFFICE BUILDING