

# COLUMBUS ONCOLOGY ASSOCIATES

810 JASONWAY BLVD  
COLUMBUS, OHIO

ARCHITECT: FEINKNOPF MACIOCE SCHAPPA ARCHITECTS, INC.  
214 MARCONI BOULEVARD  
COLUMBUS, OHIO 43215  
614/221-3192  
614/221-5601 FAX

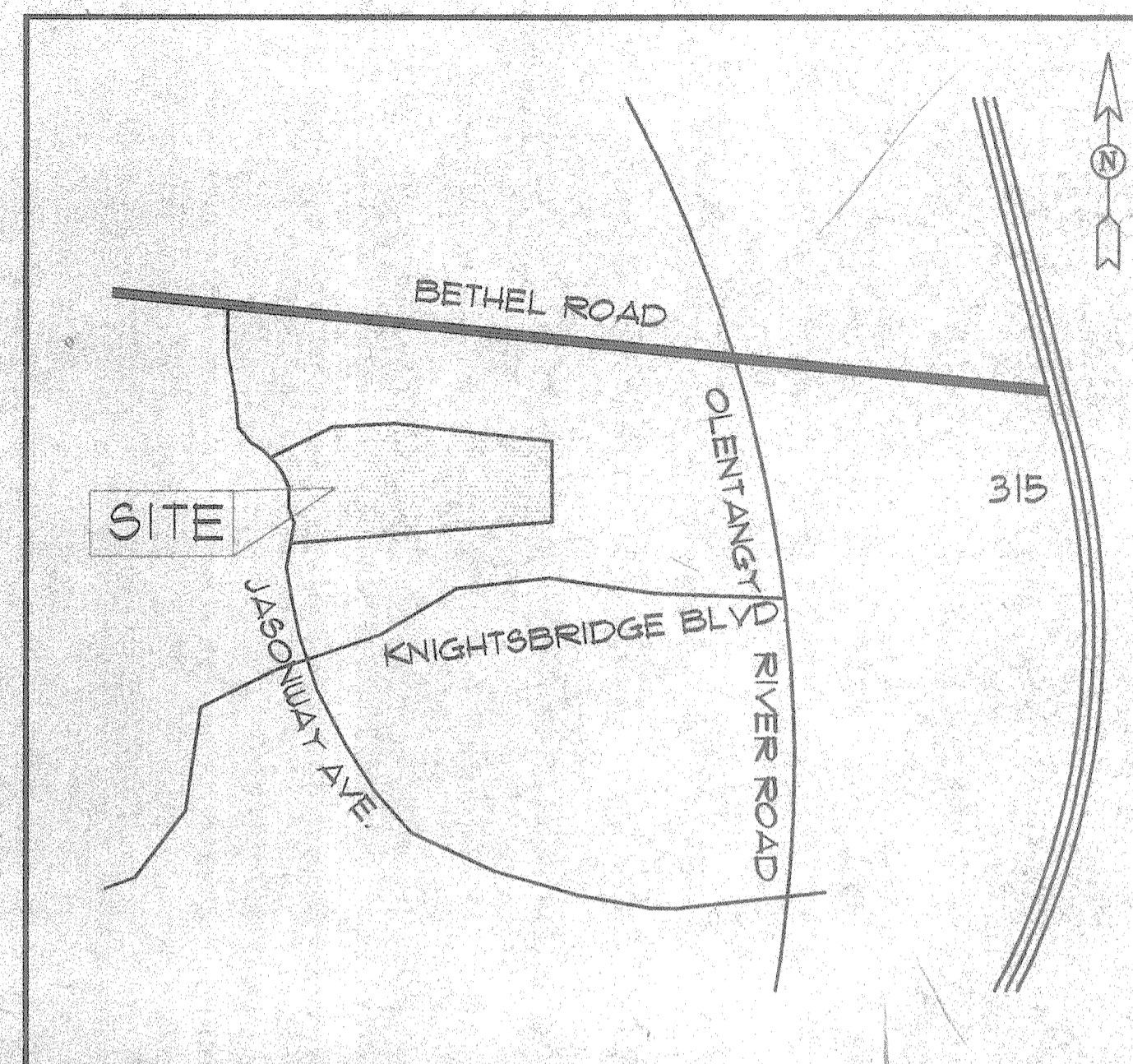

VICINITY MAP:

SYMBOLS	ABBREVIATIONS	ABBREVIATIONS	ABBREVIATIONS	ABBREVIATIONS	ABBREVIATIONS	
<p>used as abbreviations</p> <p>ANGLE CENTERLINE CHANNEL PENNY PERPENDICULAR PLATE ROUND</p>	<p>ABV ABOVE AFF ABOVE FINISHED FLOOR ACT ACOUSTICAL TILE ADD ADDENDUM ADJ ADJACENT AGG AGGREGATE A/C AIR CONDITIONING ALT ALTERNATE AL ALUMINUM AB ANCHOR BOLT ANOD ANODIZED APPROX APPROXIMATE ARCH ARCHITECTURAL AD AREA DRAIN BSMT BASEMENT BRG BEARING BM BENCH MARK BET BETWEEN BVL BEVELED BIT BITUMINOUS BLK BLOCK BLKG BLOCKING BD BOARD BOT BOTTOM BRK BRICK BLDG BUILDING CAB CABINET CI CAST IRON CB CATCH BASIN CK CALK(ING), CAULK(ING) CLG CEILING CHT CEILING HEIGHT CEM CEMENT CM CENTIMETER(S) CER CERAMIC CT CERAMIC TILE CHBD CHALKBOARD CIR CIRCLE CLR CLEAR(ANCE) COL COLUMN COMB COMBINATION CONC CONCRETE CMU CONCRETE MASONRY UNIT CONST CONSTRUCTION CONT CONTINUOUS, CONTINUE CJ CONTROL JOINT CG CORNER GUARD CS COUNTERSINK CRS COURSE(S) CFT CUBIC FOOT CYD CUBIC YARD DL DEAD LOAD DTL DETAIL DIAG DIAGONAL DIAM(D) DIAMETER DIM DIMENSION DR DOOR DS DOWNSPOUT DT DRAIN TILE DUG DRAWING DF DRINKING FOUNTAIN E EAST ELEC ELECTRIC(AL) EWC ELECTRIC WATER COOLER ELEV ELEVATOR, ELEVATION EMER EMERGENCY EQ EQUAL</p>	<p>EQUIP EQUIPMENT EST ESTIMATE EXH EXHAUST EXG EXISTING EB EXPANSION BOLT EXP J EXPANSION JOINT EXP EXPOSED EXT EXTERIOR FC FACE OF CONCRETE FF FACE OF FINISH FM FACE OF MASONRY FS FACE OF STUDS FIN FINISHED FA FIRE ALARM/FRESH AIR FE FIRE EXTINGUISHER FEC FIRE EXTINGUISHER CABINET FHS FIRE HOSE STATION FP FIREPROOF FLG FLASHING FLR FLOOR(ING) FD FLOOR DRAIN FLUR FLUORESCENT FTG FOOTING FNDN FOUNDATION FUT FUTURE GA GAGE, GAUGE GALV GALVANIZED GC GENERAL CONTRACTOR GL GLASS, GLAZING GB GRAB BAR GYP GYPSUM HDW HARDWARE HVAC HEATING/VENTILATING/AIR COND. HD HEAVY DUTY HT HEIGHT HEX HEXAGONAL HC HOLLOW CORE HM HOLLOW METAL HORIZ HORIZONTAL HB HOSE BIBB HUH HOT WATER HEATER INCL INCLUDE(D), (ING) ID INSIDE DIAMETER INS INSULATE(D), (ION) INT INTERIOR INTM INTERMEDIATE INV INVERT IPS IRON PIPE SIZE JT JOINT KIT KITCHEN KO KNOCKOUT LAB LABORATORY LB LAG BOLT LAM LAMINATE (D) LAV LAVATORY LH LEFT HAND L LENGTH LT LIGHT LL LIVE LOAD LYR LOUVER MB MACHINE BOLT MH MANHOLE MFR MANUFACTURE (ER) MASONRY MASONRY MO MASONRY OPENING MTL MATERIAL (S) MAX MAXIMUM</p>	<p>MECH MECHANIC (AL) MED MEDIUM MTL METAL MM MILLIMETER (S) MIN MINIMUM MISC MISCELLANEOUS MOD MODULAR MOV MOVABLE MULL MULLION NAT NATURAL NRC NOISE REDUCTION COEFF. NOM NOMINAL N NORTH NIC NOT IN CONTRACT NTS NOT TO SCALE OC ON CENTER (S) OPNG OPENING OPP OPPOSITE OPH OPPOSITE HAND OD OUTSIDE DIAMETER OH OVERHEAD PNL PANEL PTN PARTITION PVT PAVEMENT PED FEDESTAL PERF PERFORATE (D) PL PLATE, PROPERTY LINE PVC POLYVINYL CHLORIDE PCF POUNDS PER CUBIC FOOT PSF POUNDS PER SQUARE FOOT PSI POUNDS PER SQUARE INCH QT QUARRY TILE RAD RADIUS RUC RAINWATER CONDUCTOR REF REFERENCE REFR REFRIGERATOR REG REGISTER RCP REINFORCED CONCRETE PIPE RES RESILIENT RET RETURN RA RETURN AIR REV REVISION (S), REVISED RH RIGHT HAND R RISER RD ROOF DRAIN RM ROOM RO ROUGH OPENING SCH SCHEDULE SCN SCREEN SEC SECTION SINK SERVICE SINK SHTG SHEATHING SHT SHEET SIM SIMILAR SC SOLID CORE S SOUTH SPEC SPECIFICATION (S) SQ SQUARE SS STAINLESS STEEL STD STANDARD STL STEEL STO STORAGE SA SUPPLY AIR SUS SUSPENDED SYM SYMMETRY (ICAL) SYS SYSTEM</p>	<p>TKBD TACKBOARD TEL TELEPHONE TV TELEVISION THK THICKNESS THR THRESHOLD TOL TOLERANCE TAG TONGUE AND GROOVE T TREAD, TOP TYP TYPICAL UN UNFINISHED UR URINAL VB VAPOUR BARRIER VERT VERTICAL WC WATER CLOSET WPF WATER PROOFING WUF WELDED WIRE FABRIC W WIDTH, WIDE, WEST WO WITHOUT WD WOOD</p>	<p>GENERAL NOTES</p> <ol style="list-style-type: none"> <li>ALL WORK IS TO BE EXECUTED IN CONFORMANCE WITH ALL APPLICABLE NATIONAL, STATE AND LOCAL CODES.</li> <li>THE CONTRACTOR IS TO VERIFY ALL EXISTING CONDITIONS PRIOR TO COMMENCING CONSTRUCTION. SHOULD DISCREPANCIES OCCUR BETWEEN THE DRAWINGS AND ACTUAL FIELD CONDITIONS, THE CONTRACTOR IS TO NOTIFY THE ARCHITECT IMMEDIATELY.</li> <li>DO NOT SCALE DRAWINGS. ANY DISCREPANCIES IN DIMENSION SHOULD BE BROUGHT TO THE ATTENTION OF THE ARCHITECT PRIOR TO PROCEEDING FURTHER WITH THE WORK.</li> <li>THE CONTRACTOR IS TO VERIFY WITH OWNER ALL ITEMS TO BE FURNISHED AND INSTALLED BY OWNER UNDER SEPARATE CONTRACTS. PRIOR TO COMMENCING CONSTRUCTION THE CONTRACTOR WILL ALSO COORDINATE WORK WITH OWNER-FURNISHED ITEMS AND IS TO REINFORCE, BRACE, AND PROVIDE ADEQUATE BLOCKING AS MAY BE REQUIRED FOR INSTALLATION OF OWNER-FURNISHED ITEMS.</li> </ol>	<p>DRAWING LIST</p> <p>COVER SHEET</p> <p>A-1 FIRST FLOOR PLAN A-2 SECOND FLOOR PLAN A-3 FIRST FLOOR REFLECTED CEILING PLAN A-4 SECOND FLOOR REFLECTED CEILING PLAN A-5 FIRST FLOOR FINISH PLAN A-6 SECOND FLOOR FINISH PLAN A-7 ENLARGED ELEVATIONS &amp; INTERIOR ELEVATIONS</p> <p>F-1 FIRST FLOOR PLUMBING PLAN F-2 SECOND FLOOR PLUMBING PLAN</p> <p>E-1 FIRST FLOOR ELECTRIC PLAN E-2 SECOND FLOOR ELECTRIC PLAN E-3 PANELBOARD SCHEDULES E-4 FIRST FLOOR ELECTRIC LIGHTING E-5 SECOND FLOOR ELECTRIC LIGHTING</p>
<p>symbols</p> <p>10 A4 BUILDING SECTION reference drawing number</p> <p>10 A4 WALL SECTION OR ELEVATION reference drawing number</p> <p>10 A4 DETAIL reference drawing number</p> <p>10 A4 C ELEVATION TAG reference drawing number</p> <p>INDICATES SECTION NUMBER ON WHICH SECTION IS SHOWN</p> <p>INDICATES DRAWING SHEET ON WHICH SECTION IS SHOWN</p> <p>INDICATES DETAIL NUMBER ON WHICH DETAIL IS SHOWN</p> <p>BREAK LINE</p> <p>DASH &amp; DOT LINE center lines, floor lines in exterior elevations, projected lines</p> <p>DASH &amp; DOUBLE DOT LINE property lines, boundary lines</p> <p>DOTTED LINE</p> <p>INDICATES DIMENSION TO ACTUAL FACE OF MATERIAL</p> <p>INDICATES DIMENSION TO CENTERLINE</p> <p>ELEVATION LINE</p> <p>COLUMN LINE</p>	<p>12 MATCH LINE</p> <p>WINDOW TAG</p> <p>12 DOOR TAG</p> <p>REVISION MARK</p> <p>CODED NOTES</p> <p>ROOM FINISH KEY</p> <p>Ceiling Doors Floors</p> <p>NORTH ARROW</p> <p>EXISTING CONTOUR LINE</p> <p>PROPOSED CONTOUR LINE</p> <p>LAYOUT STARTING POINT</p> <p>TEST BORING</p> <p>EXISTING CONSTRUCTION TO BE REMOVED</p> <p>EXISTING CONSTRUCTION TO REMAIN</p> <p>NEW CONSTRUCTION</p> <p>EXISTING DOORS TO BE REMOVED</p> <p>EXISTING DOORS TO REMAIN</p> <p>NEW DOORS</p> <p>SURFACES TO BE ALIGNED</p>	<p>MATERIAL INDICATIONS</p> <p>EARTH</p> <p>POROUS FILL (gravel, stone)</p> <p>CONCRETE</p> <p>CONCRETE MASONRY UNITS</p> <p>BRICK</p> <p>METAL (large scale)</p> <p>WOOD FINISHED</p> <p>PLYWOOD</p> <p>WOOD (dimensional, continuous)</p> <p>WOOD (dimensional, non-continuous)</p> <p>WOOD FINISHED</p> <p>INSULATION (loose or batt)</p> <p>INSULATION (rigid)</p> <p>GYPSUM WALL BD. (fiberboard ect.)</p> <p>SPRAY ON FIREPROOFING</p> <p>METAL (small scale structural and sheet)</p>	<p>OHIO BASIC BUILDING CODE (OBBC) SUMMARY</p> <p>USE GROUP: B, BUSINESS (MEDICAL OFFICE)</p> <p>CONSTRUCTION TYPE: 5B COMBUSTIBLE UNPROTECTED</p> <p>BUILDING AREA: 32,400 SF (OBBC TABLE 503, OBBC 506.2, OBBC 506.3)</p> <p>BUILDING HEIGHT: 3 STORIES 50' (OBBC TABLE 503, OBBC 504.2)</p> <p>REQUIRED FIRE RESISTANCE RATINGS: STRUCTURAL ELEMENT:</p> <ol style="list-style-type: none"> <li>EXTERIOR WALLS</li> <li>FIRE WALLS/ PARTY WALLS</li> <li>FIRE SEPARATION ASSEMBLIES EXITS (STAIRS) SHAFTS, ELEVATOR HOISTWAYS MIXED USE OTHER SEPARATION ASSEMBLIES</li> <li>FIRE PARTITIONS EXIT ACCESS CORRIDORS</li> <li>DWELLING UNIT SEPARATIONS</li> <li>SMOKE BARRIERS</li> <li>OTHER NONLOADBEARING PARTITIONS</li> <li>INTERIOR LOADBEARING WALLS, PARTITIONS, COLUMNS, GIRDERS, TRUSSES, FRAMING</li> <li>STRUCTURAL MEMBERS SUPPORTING A WALL</li> <li>FLOOR CONSTRUCTION INCLUDING BEAMS</li> <li>ROOF CONSTRUCTION</li> </ol> <p>RATING REQUIRED: 0 (OBBC TABLE 105.2; FIRE SEPARATION DISTANCE IS GREATER THAN 10' TO 15')</p> <p>ACTUAL: 1 (OBBC 104.1) 1 (OBBC 110.3) NA NA 0 (TABLE 10211.4) NA NA 0 (OBBC TABLE 602) NOT LESS THAN THE WALL SUPPORTED (OBBC TABLE 602) 0 (OBBC TABLE 602) 0 (OBBC TABLE 602)</p> <p>ACTUAL: 2 STORIES: 35'</p> <p>ACTUAL: 2 (ULL DESIGN No. U-305) 3 (ULL DESIGN No. U-305) 12,166 SF.</p>			

95062-03

COLUMBUS ONCOLOGY ASSOCIATES