

6631 Commerce Parkway, Studio B
Dublin, Ohio 43017
Phone: 614-766-1117
Fax: 614-766-2023
E-mail: WAarch@aol.com

All drawings and written material appearing herein constitute the original and unpublished work of the Architect and may not be duplicated, used, or disclosed without the prior written consent of the Architect. © 1997 William Andrews Architects

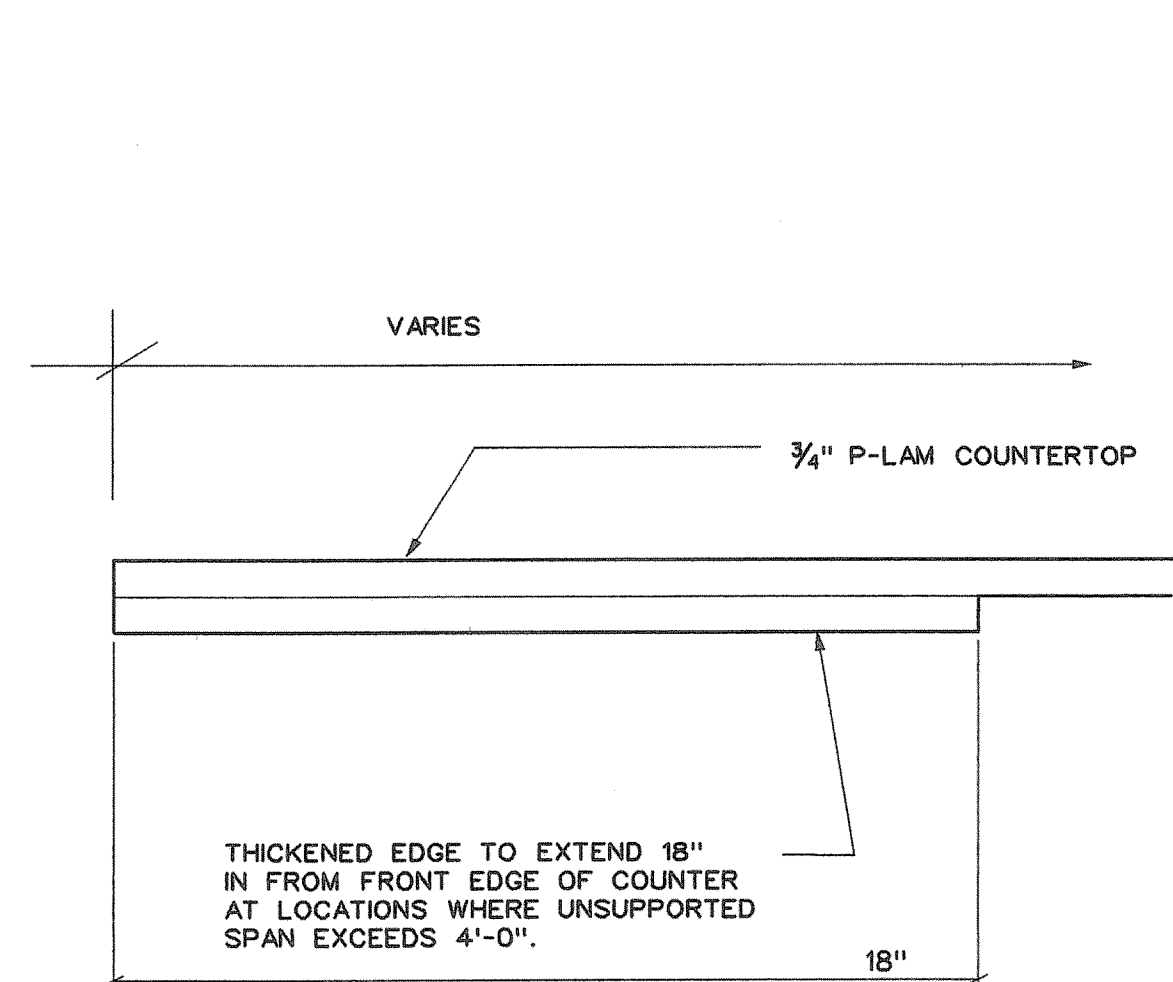

A Countertop Edge Detail
Scale: 3"=1'-0"

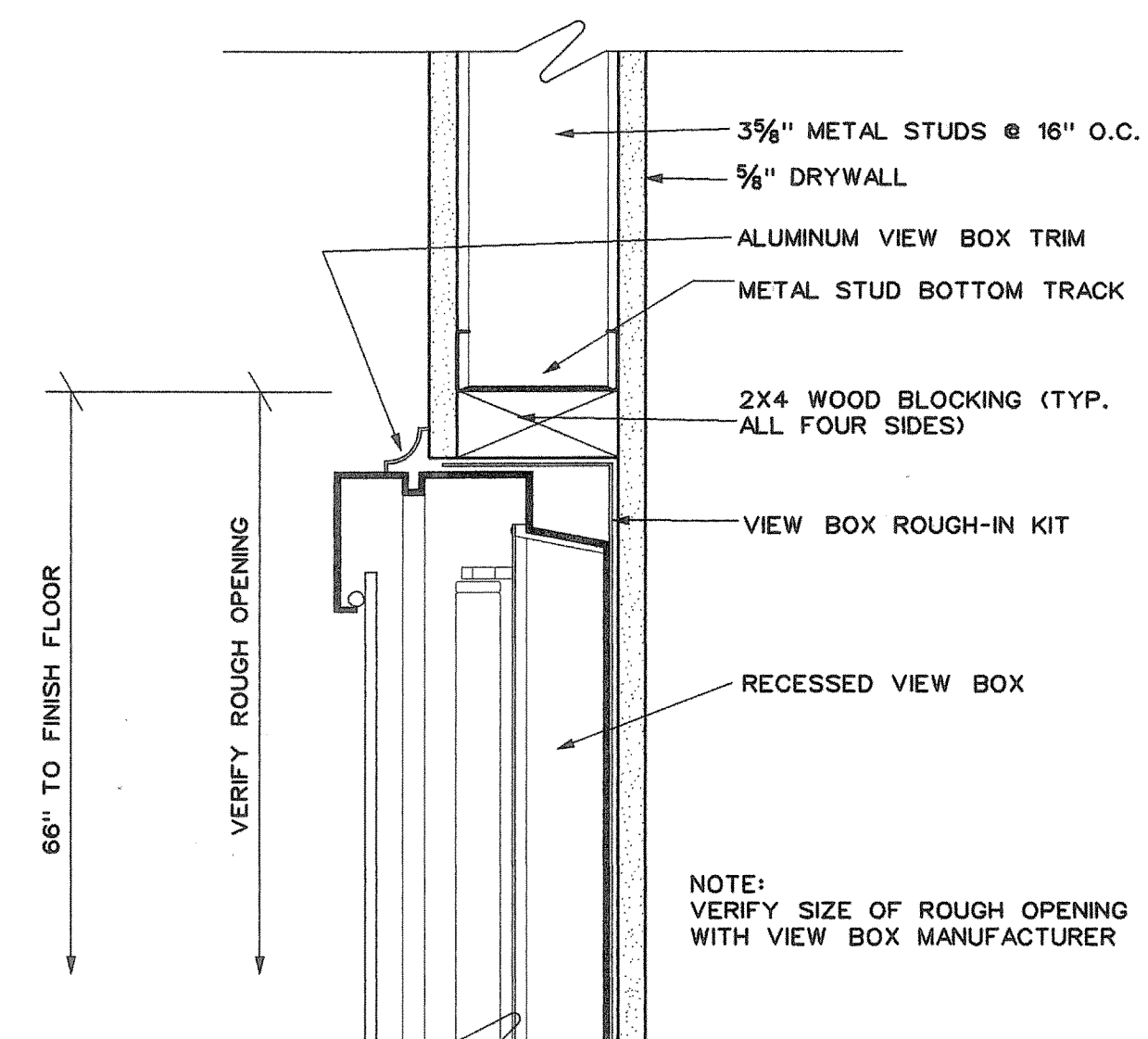

B Recessed X-Ray View Box Detail
Scale: 3"=1'-0"

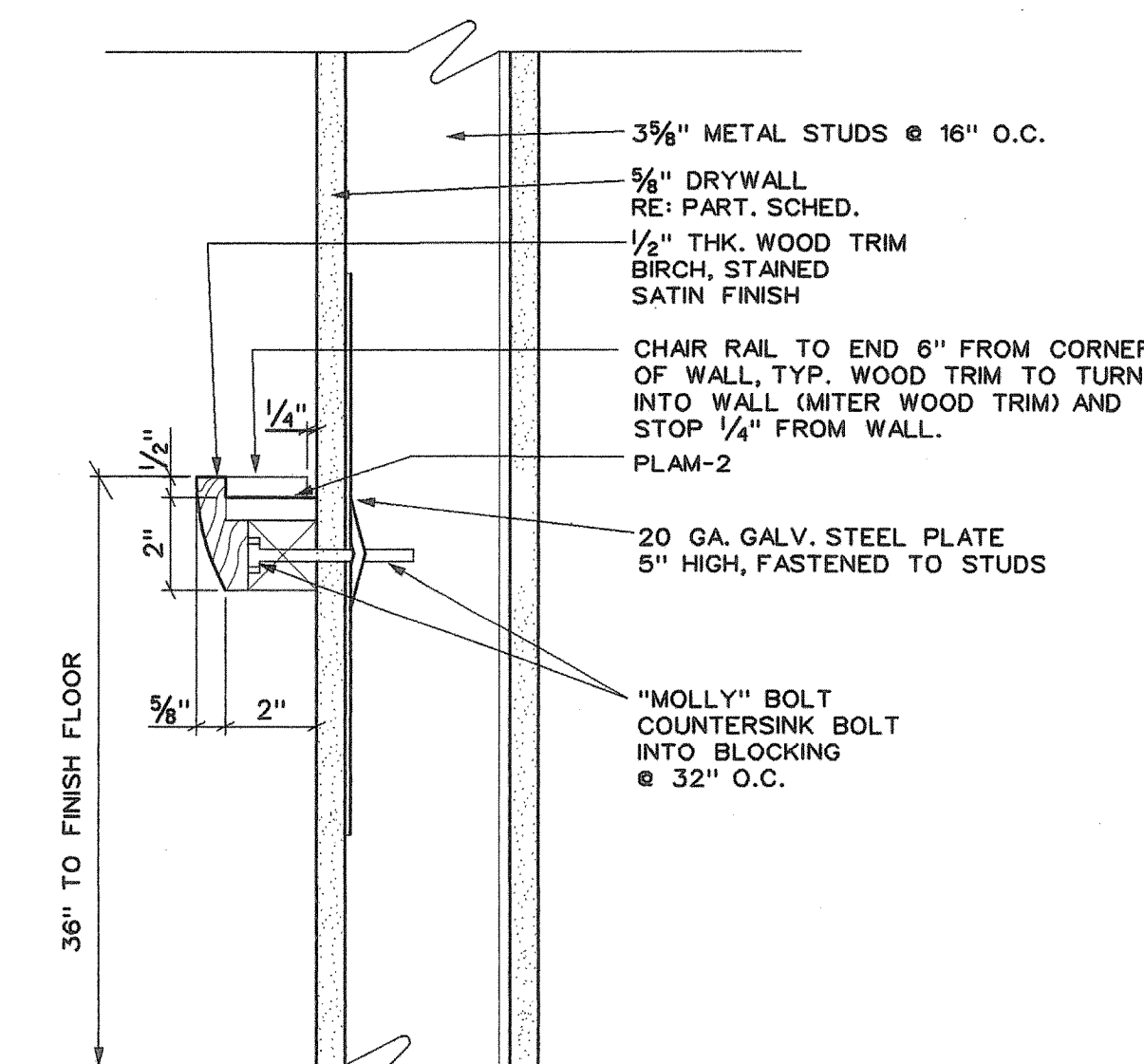

C Chair Rail Detail
Scale: 3"=1'-0"

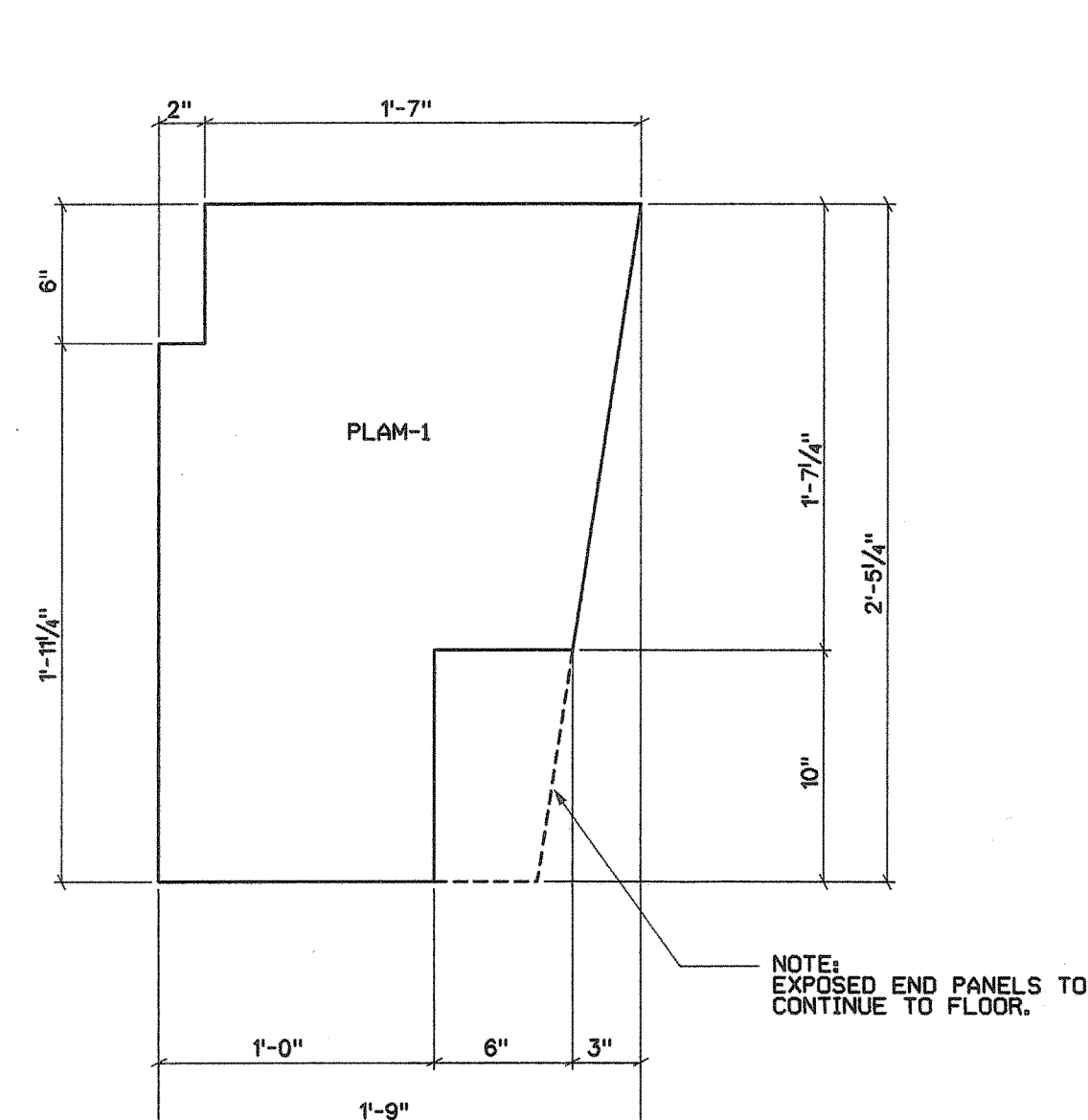

D P-Lam Support Panel
Scale: 1 1/2"=1'-0"

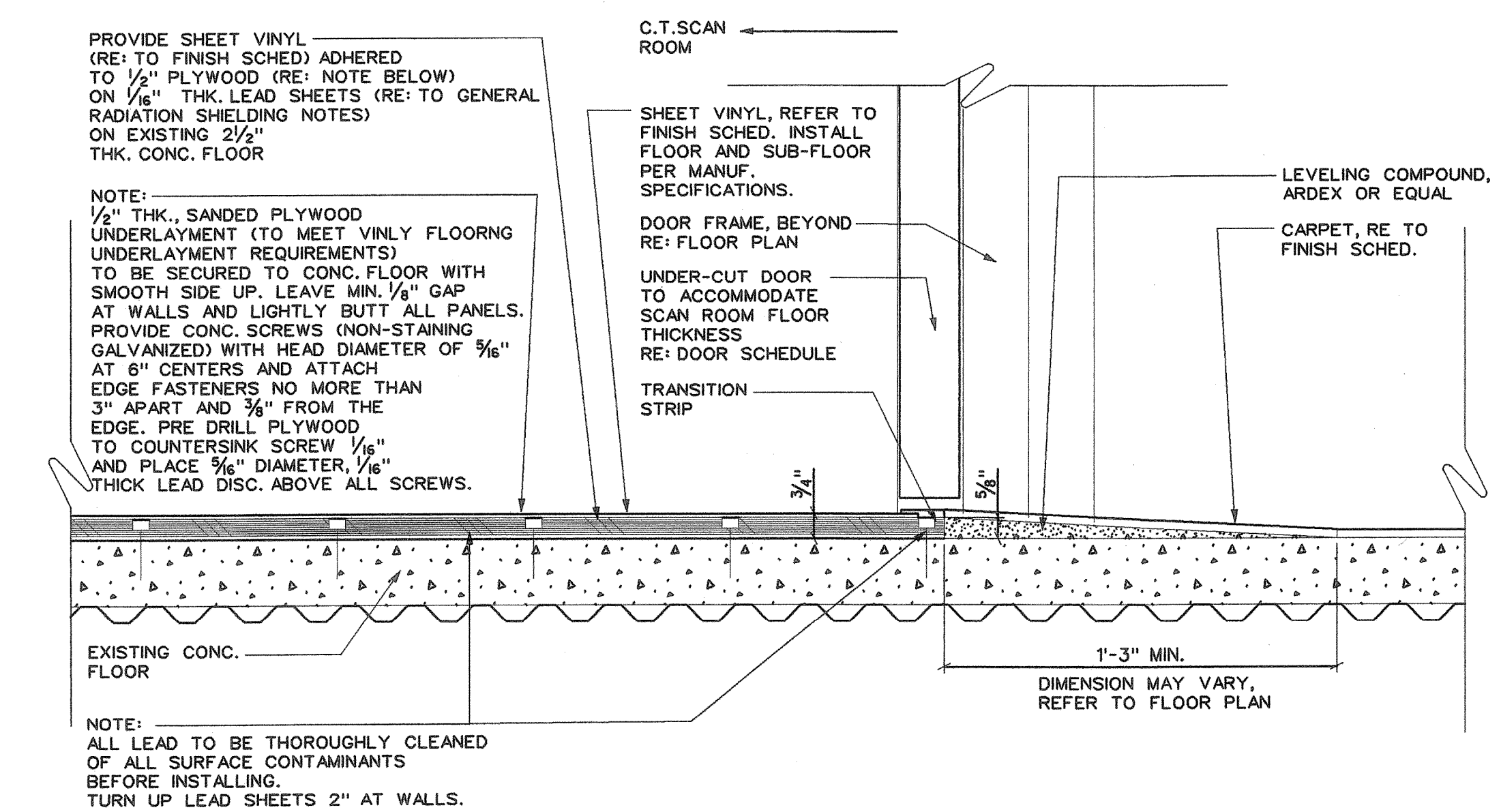

E Lead Floor Detail
Scale: 3"=1'-0"

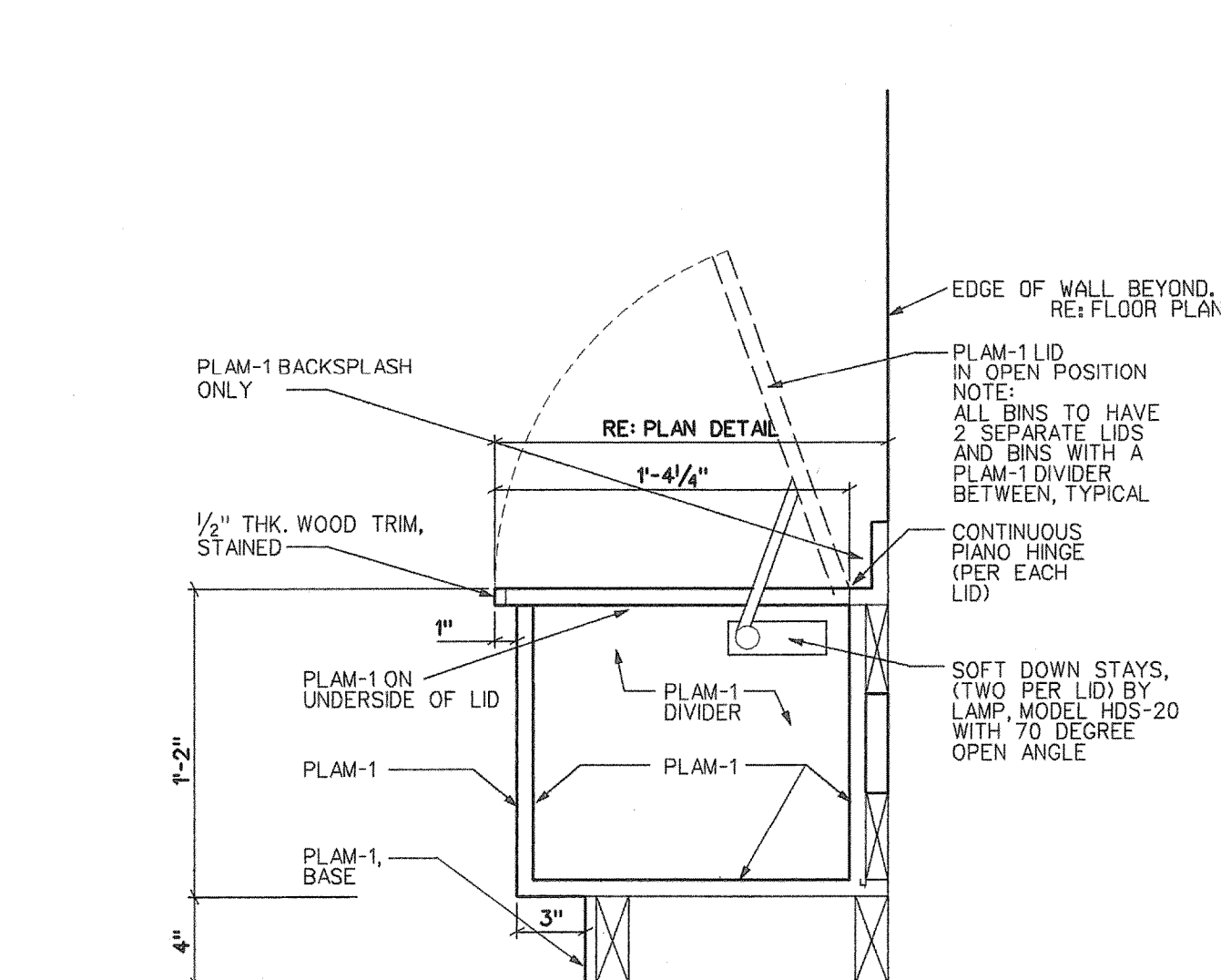

F Plam. Bin Detail
Scale: 1 1/2"=1'-0"

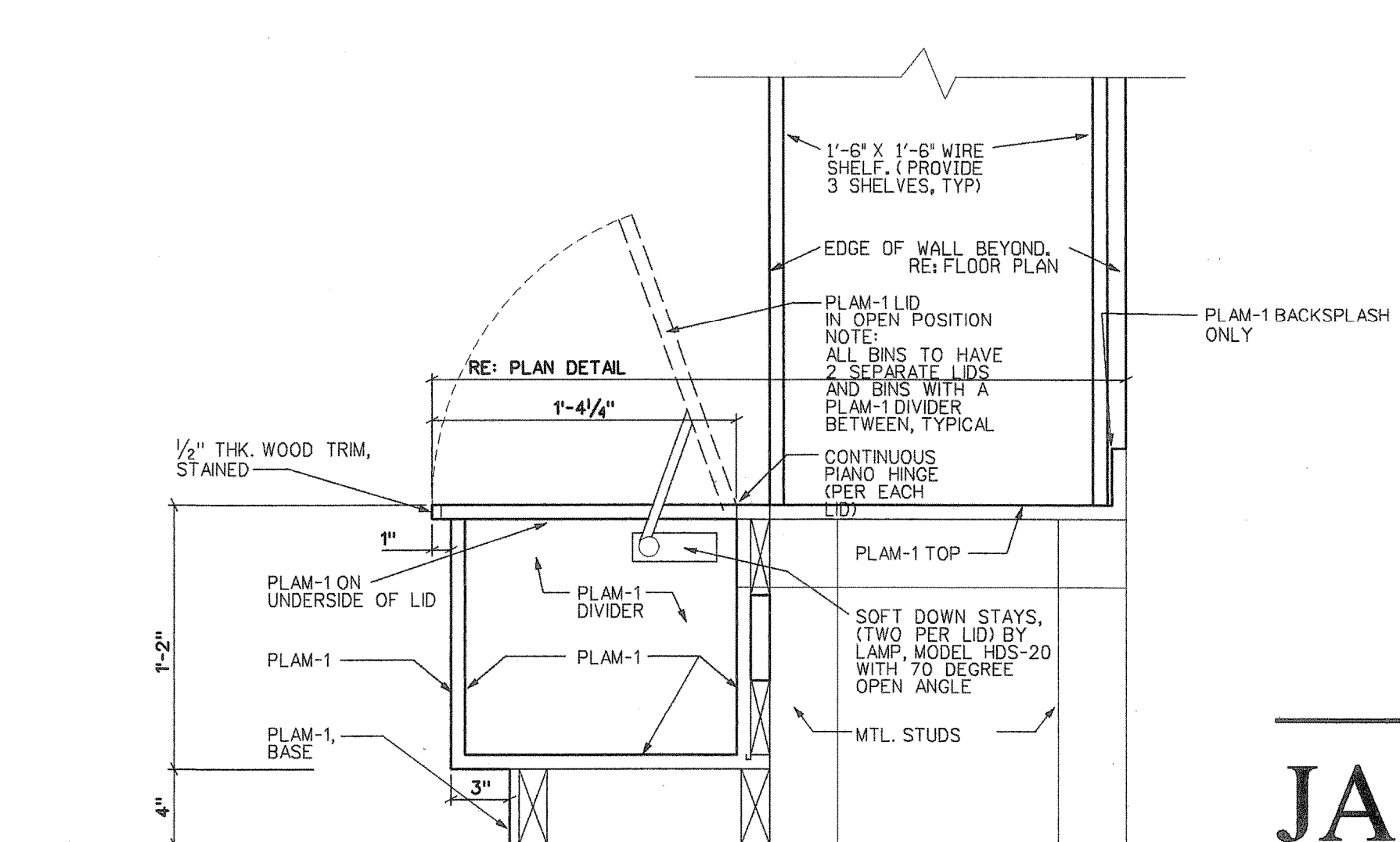

G Plam. Bin Detail
Scale: 1 1/2"=1'-0"

JASONWAY IMAGING CENTER

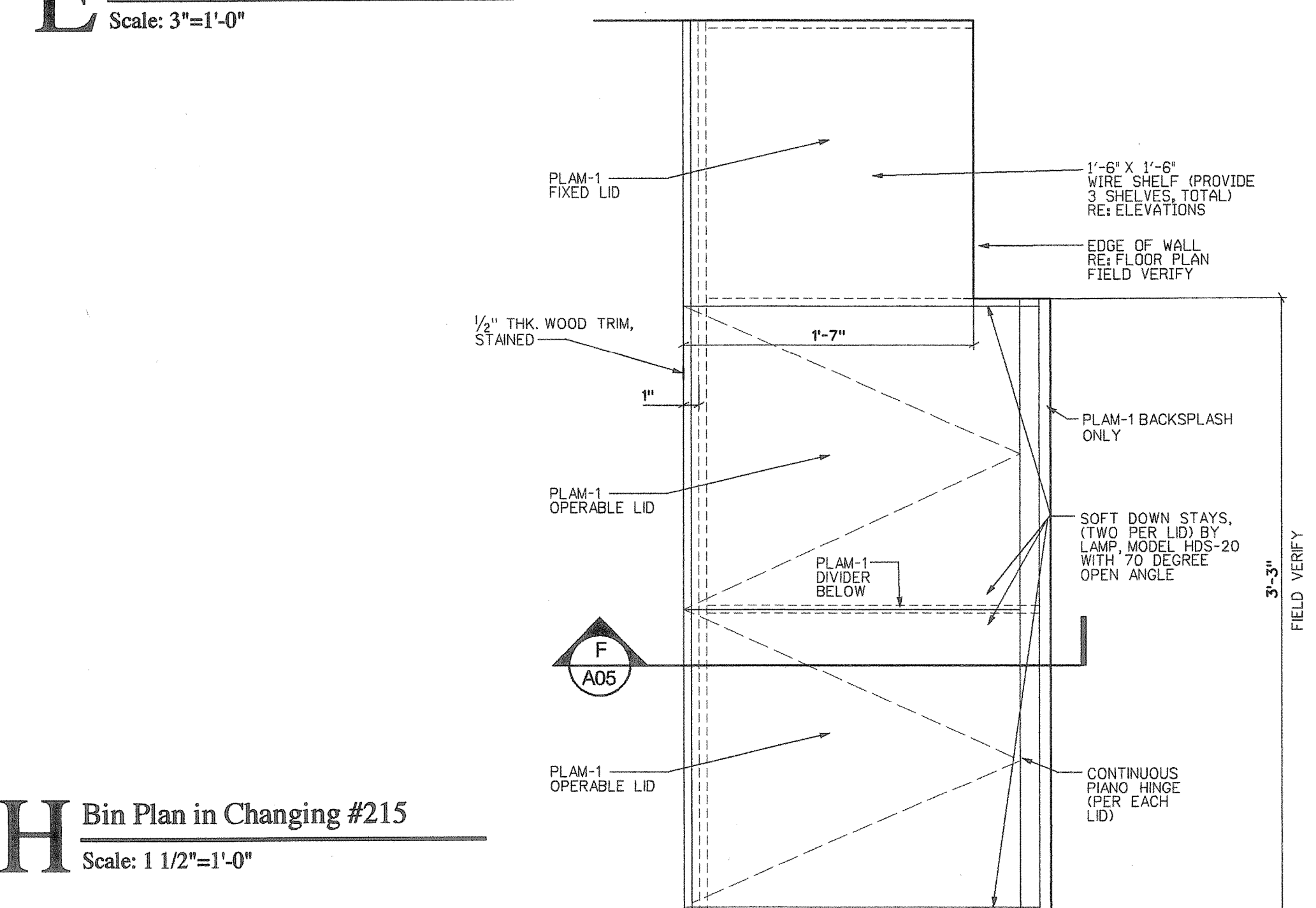

H Bin Plan in Changing #215
Scale: 1 1/2"=1'-0"

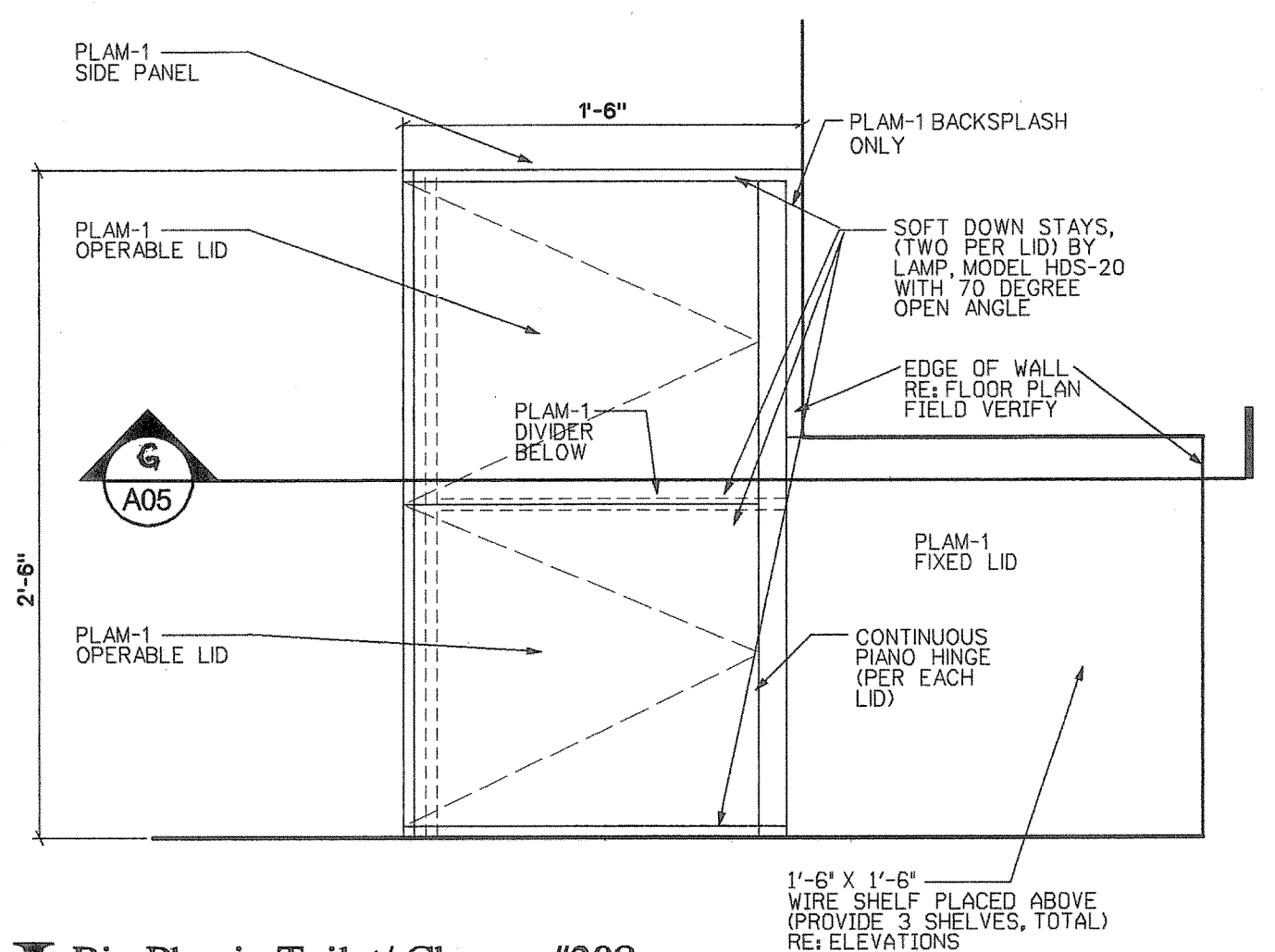

I Bin Plan in Toilet/ Change #208
Scale: 1 1/2"=1'-0"

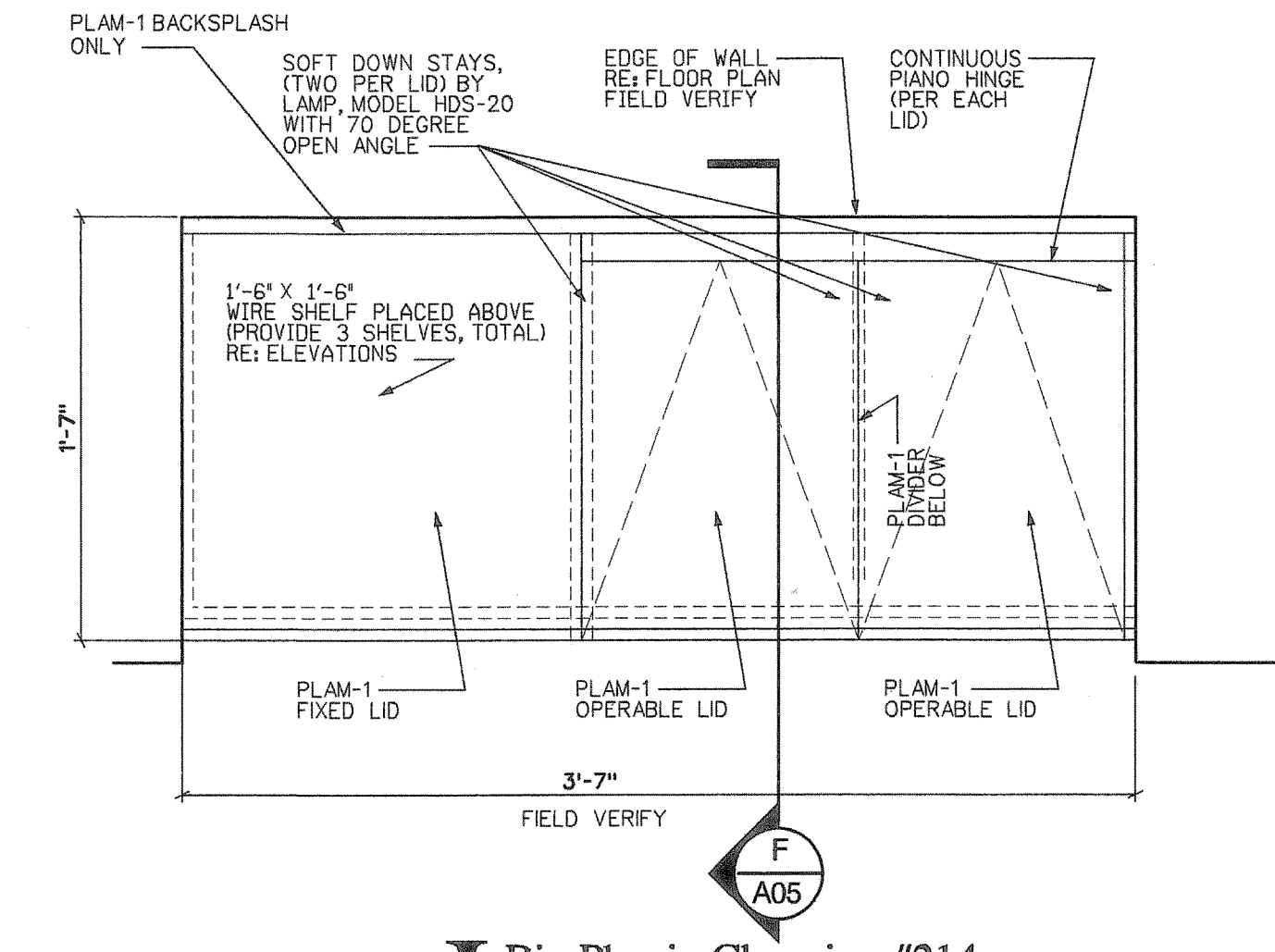

J Bin Plan in Changing #214
Scale: 1 1/2"=1'-0"

FEB. 6th, 1998 PROJ. No.: 97045

| | | |
|--|-----|------------------|
| <input type="checkbox"/> SCHEMATIC DESIGN | --- | △ REVISION No. 1 |
| <input type="checkbox"/> DESIGN DEVELOPMENT | --- | △ REVISION No. 2 |
| <input type="checkbox"/> DESIGN DEV. SIGN-OFF | --- | △ REVISION No. 3 |
| <input type="checkbox"/> BIDDING | --- | △ REVISION No. 4 |
| <input type="checkbox"/> BLDG. PERMIT SUBMISSION | --- | △ REVISION No. 5 |
| <input checked="" type="checkbox"/> CONSTRUCTION | --- | △ REVISION No. 6 |
| <input type="checkbox"/> NOT FOR CONSTRUCTION | --- | |
| <input type="checkbox"/> RECORD / FILE | --- | |

INTERIOR DETAILS

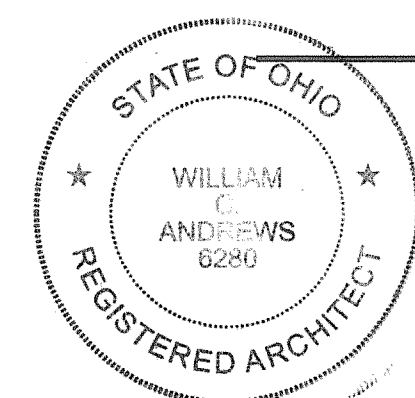

A-05